



## Color CCD MicroCamera Head 1/10''

SMCC10027

### Features

- Extremely miniaturized colour CCD camera (2,7 \* 2 \* 6,7 mm)
- Light Weight (0,20 gr)
- Long length cables driving capability (up to 10 meters)
- High resolution (Ye, Cy, Mg and G complementary colour mosaic filter)
- High sensitivity and low smear
- No voltage adjustment (Reset Gate and substrate bias are not adjusted)
- Low dark current
- Excellent anti blooming characteristics
- Continuous variable-speed shutter
- Field period readout system
- Variable charge-storage time electronic shutter
- Recommended range of exit pupil distance : -10 mm to  $-\infty$

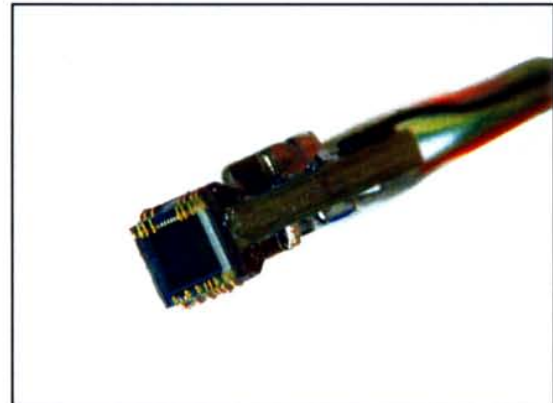

- Custom application :  
Endoscope camera head in its housing



### General Description

The 3D- $\mu$ Camera is a highly miniaturized, light weight, high performance and easy-to-use colour CCD Camera for endoscopes applications. The innovative design makes them suitable also for applications in the area of robotics, assembly and mounting devices or manipulators. It embeds state-of-the art Sony colour CCD sensors with high resolution and sensitivity, low smear and dark current, and excellent anti blooming characteristics.

The embedded electronics grant the  $\mu$ camera with a long cables driving capability : up to 10 meters of cable can be connected between the camera head and the base station.

It is available for PAL and NTSC video systems.



# Color CCD MicroCamera Head 1/10''

## SMCC10027

### Technical features

<b>Features</b>	
Video System :	PAL
Image Sensor :	Interline 1/10'' CCD ( 290.000 pixels)
Active Pixel Size :	2,95 $\mu\text{m}$ (H) x 1,90 $\mu\text{m}$ (V)
Sensor Area :	1,5 mm (H) x 1,1 mm (V)
Number of picture elements :	PAL 500 (H) x 582 (V)
Sensitivity :	< 2,67 lx at 0 dB
	< 0,53 lx at 14 dB ( at 20ms integration, 50% video level, Gamma 0,45)
Spectral sensitivity : (incl. Infrared blocking filter)	380 – 780 nm
Filter :	Built-in infrared blocking filter
<b>Environment</b>	
Temperature (operating) :	- 10 °C / +45°C
Relative humidity :	10 to 90 % non-condensing
<b>Dimensions</b>	
Dimensions :	2,7 * 2 * 6,7 mm

### Mechanical drawing and Pin assignment

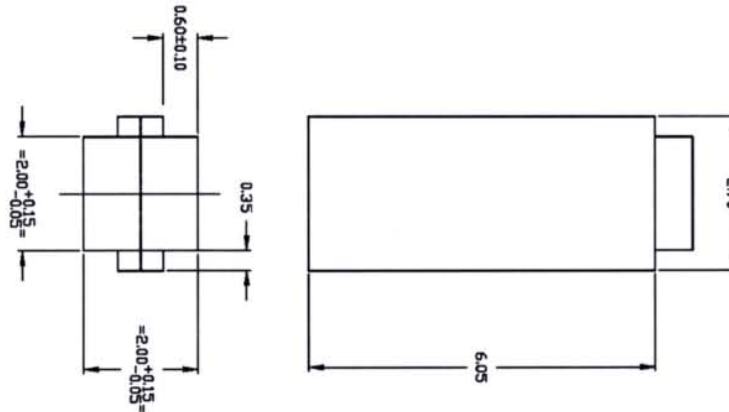

### References

- SONY CCD Image Sensor ICX257FKW (PAL video system).

### Main Sales Office

<b>FRANCE</b>	3D PLUS 641, rue Hélène Boucher ZI. 78532 BUC Cedex	Tel : 33 (0)1 30 83 26 50	Fax : 33 (0)1 39 56 25 89	Web : <a href="http://www.3d-plus.com">www.3d-plus.com</a> e-mail : <a href="mailto:sales@3d-plus.com">sales@3d-plus.com</a>
<b>North America</b>	3 D PLUS USA, Inc. 2570 Eldorado Parkway, Suite 150 McKinney, TX 75070	Tel : (1) 214 733-8505	Tel : (1) 214733-8506	e-mail : <a href="mailto:jquinn@3d-plususa.com">jquinn@3d-plususa.com</a>